

GRIP HEATER

Accessory Name	Parts Number	Application Model	Issue Date	Publication No.	FRT
GRIP HEATER	08T70-MKW-D70	NC750XA/XD	2024.09	MII	0.7 H

Introduction

ALL INFORMATION, ILLUSTRATIONS, DIRECTIONS AND SPECIFICATIONS INCLUDED IN THIS PUBLICATION ARE BASED ON THE LATEST PRODUCT INFORMATION AVAILABLE AT THE TIME OF APPROVAL FOR PRINTING. Honda Motor Co., Ltd. RESERVES THE RIGHT TO MAKE CHANGES AT ANY TIME WITHOUT NOTICE AND WITHOUT INCURRING ANY OBLIGATION WHATSOEVER. NO PART OF THIS PUBLICATION MAY BE REPRODUCED WITHOUT WRITTEN PERMISSION. THIS MANUAL IS WRITTEN FOR PERSONS WHO HAVE ACQUIRED BASIC KNOWLEDGE OF MAINTENANCE ON Honda MOTORCYCLES, MOTOR SCOOTERS OR ATVS.

Honda Dealer:







Please give a copy of these instructions to your customer.

Customer:

Because it requires specialized knowledge and special tools and equipment, it is recommended to install it at a dealer with qualified automobile maintenance.

How To Read These Symbols

Your safety, and the safety of others, is very important. To help you make informed decisions we have provided safety messages and other information throughout this manual.

-  **WARNING** You CAN be KILLED or SERIOUSLY HURT if you don't follow instructions.
-  **CAUTION** You CAN be HURT if you don't follow instructions.
-  **NOTICE** The purpose of this message is to help prevent damage to your vehicle, other property, or the environment.
-  **NOTE** Things you want to know, things that are useful to know.
-  Follow the instructions of the Service Manual.
-  Follow the other symbol instructions of the "Installation Instructions BASIC".

Instruction Other Symbols

The symbols used throughout this instructions show specific service procedures. Refer to "Installation Instructions BASIC" for description of each symbol.

INFORMATION

CAUTION

- To prevent burns, allow the engine, exhaust system, radiator, etc., to cool before installing the accessory.

NOTICE

- Take care not to damage the painted surfaces of the motorcycle.

NOTE:

- Remove the right grip as instructed in the motorcycle's Service Manual.
- For secure adhesion of the grip heaters use the recommended adhesive agent (Honda Bond A) or equivalent.
- Be sure to open and close the throttle to check for smooth operation after installation of the right grip heater.
- Disconnect the negative (-) cable from the battery before installing this accessory.
- The memories of the clock will be erased when you disconnect the battery. Reset the memories after reconnecting the battery.
- Reinstall the removed parts on the motorcycle and make sure that the wires and harnesses are not pinched.
- After handle grip heater installation, check the lights (e.g. right / left turn signal lights and brake lights) for proper operation.
- Although the illustration is of NC750XA, use the same procedures for other models.

PARTS LIST

When the instruction manual and installation instructions are included in this kit, be sure to give them to the customer.

Component	No.	Parts Name	Qty	Parts No.
	(1)	Right grip heater	1	-
	(2)	Left grip heater	1	-
	(3)	Heater controller	1	35530-MJN-D12
	(4)	Suspension	1	35535-MJN-D11
	(5)	Clamp	1	35135-MJM-D60
	(6)	Wire tie	2	35701-MG9-950

SYSTEM DIAGRAM

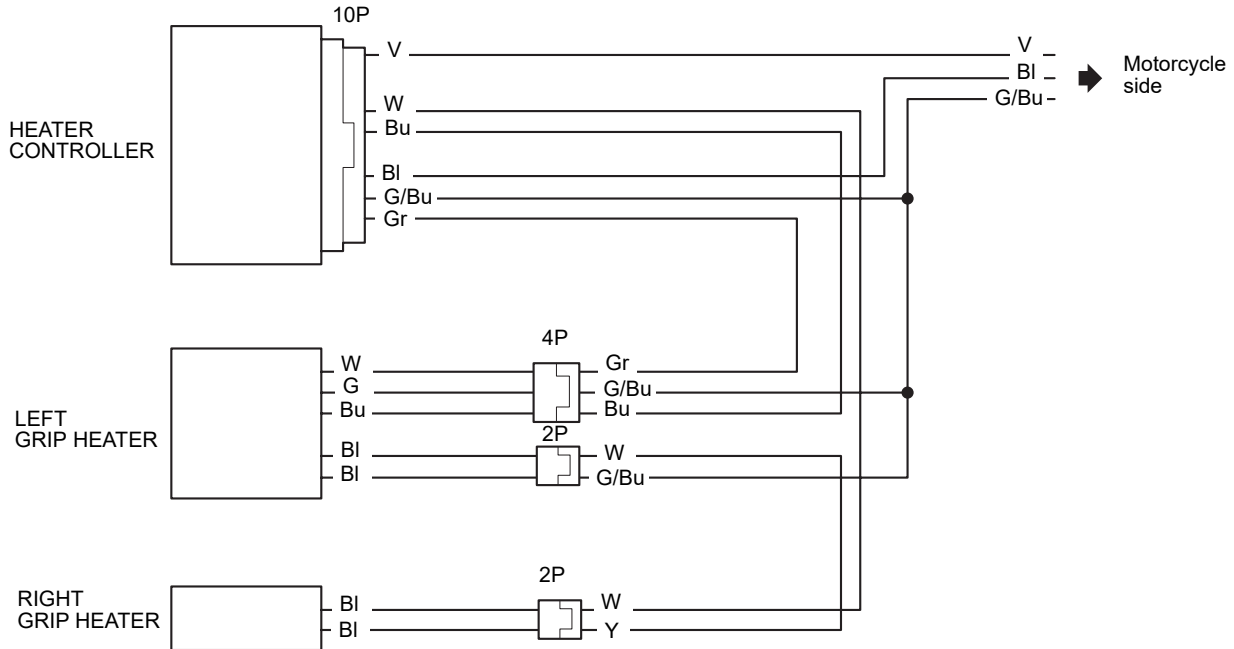

Identify wire colors:
 BI: Black
 W: White
 Bu: Blue
 G: Green
 V: Violet
 Y: Yellow

TORQUE INFORMATION

Refer to the Service Manual for the torque values including standard torque of the removed parts. (📖)

INSTALLATION

Refer to the Service Manual for the motorcycle, remove the motorcycle parts as shown, and disconnect the negative (-) cable from the battery. (📖)

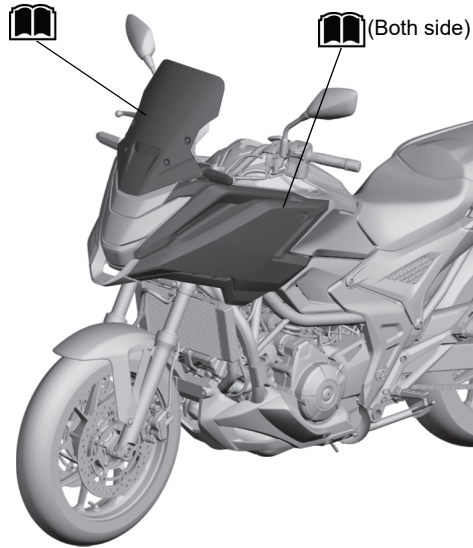

1. Remove the handlebar weight as shown.
 - Repeat on the right side.

<Left side>

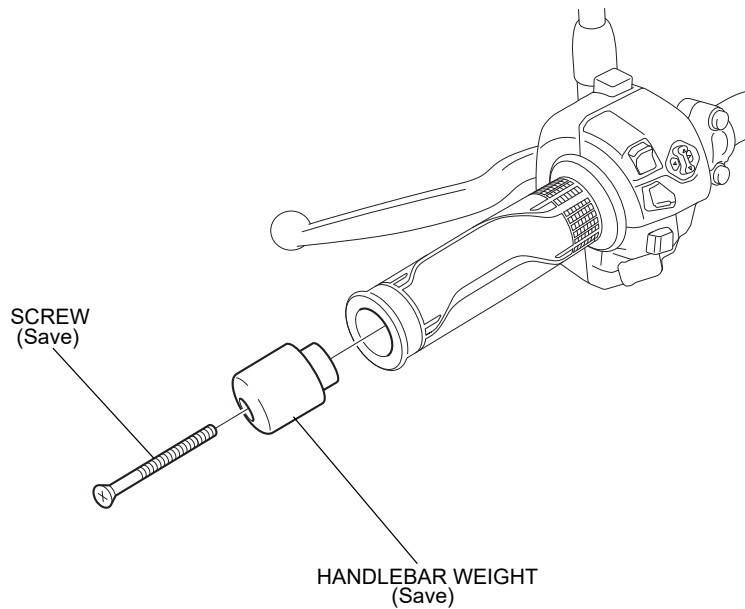

2. Remove the left grip as shown.

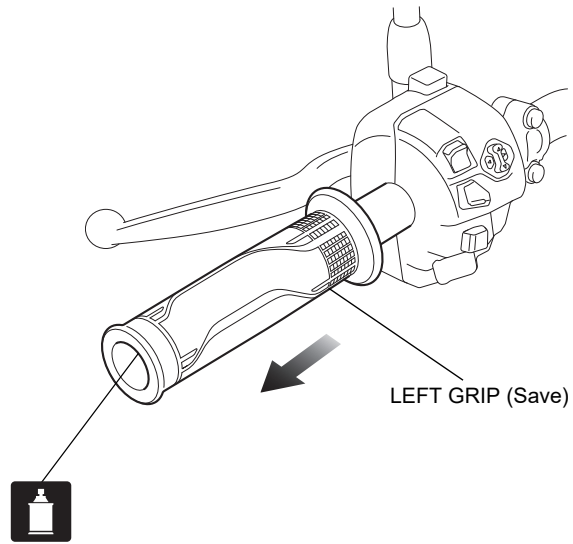

3. Using a isopropyl alcohol, remove all traces of adhesive from the left handlebar.

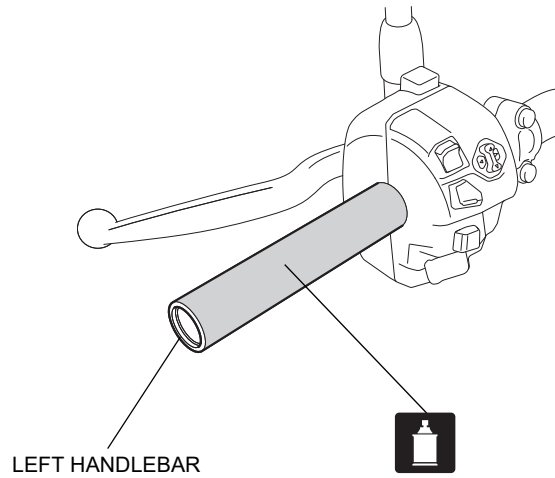

4. Remove the clip as shown.

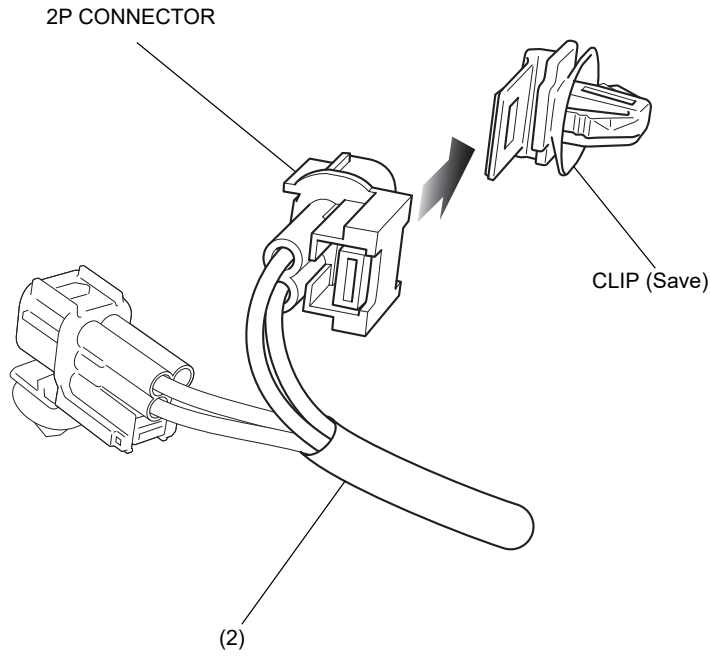

5. Liberally apply the Honda Bond A to the inside of the left grip heater from the kit as shown.

NOTE:

- Read the Instructions of the steps 5 through 8 carefully before operation and complete the installation quickly before the adhesive agent cures.
- Use an assistant to steady the motorcycle while installing the grips.

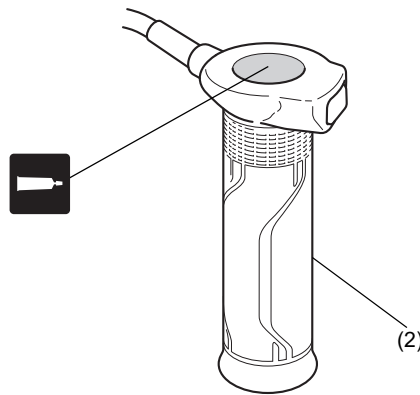

6. Apply the Honda bond A to the left handlebar as shown.

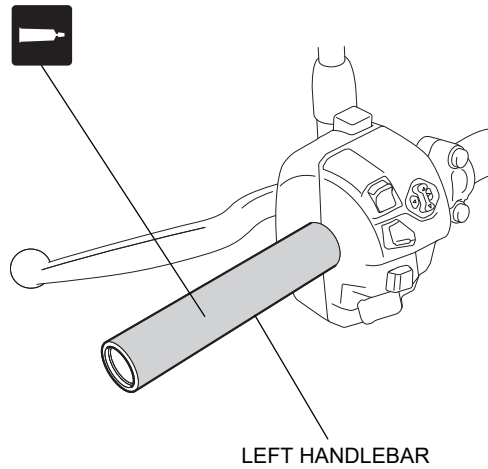

7. Spray isopropyl alcohol over the inside of the grip heater and outside of the left handlebar.
• This is done to ease alignment between the grip heater and the handlebar.

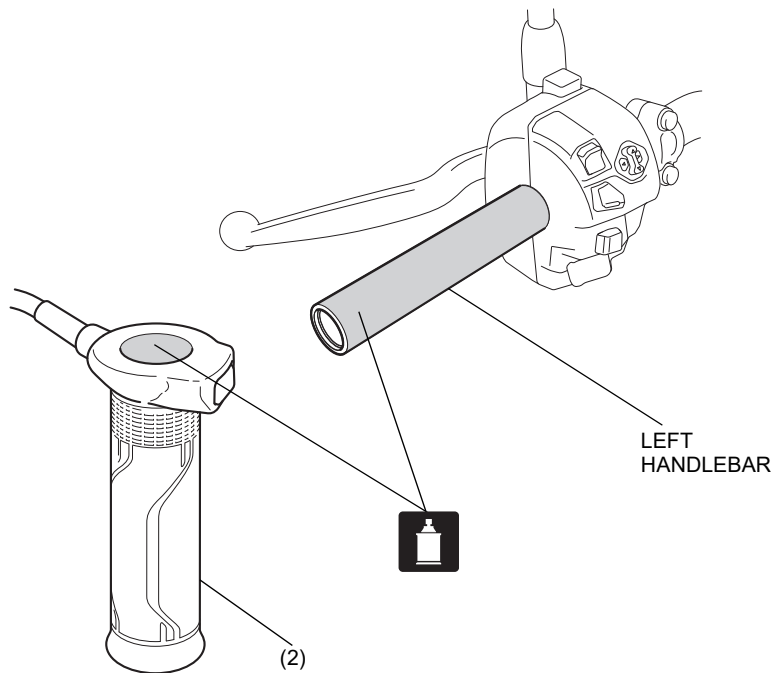

8. Slide the left grip heater onto the left handlebar as indicated.
- Use an assistant to steady the motorcycle while installing the grips.
 - Wipe up excess adhesive at once.

Liberal apply the Honda Bond A to the inside of the left grip heater from the kit as shown.

NOTICE

- Do not tap on the grip end with a hammer and do not twist the grip to install the grip heater onto the handlebar, as it can damage the element.

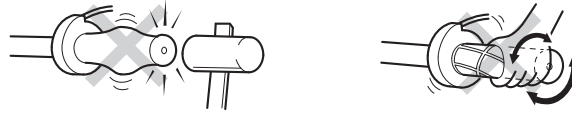

- Avoid putting pressure on the switch part when inserting the left grip heater. There is a possibility that the switch part will break. Also, install so that there is no gap with the switch holder.



- If the grip gets stuck halfway during installation, apply isopropyl alcohol to the gap between the grip heater. Do not try to remove the grip heater using force or a screwdriver, etc. Damage to the grip heater wire can result.

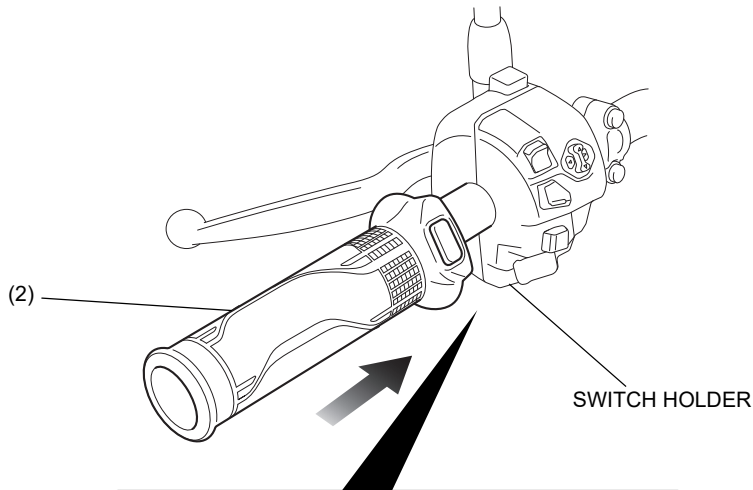

Align the indicated position.

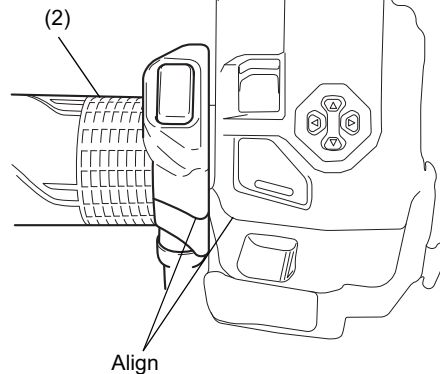

9. Route the left grip heater harness as shown.

<Left side>

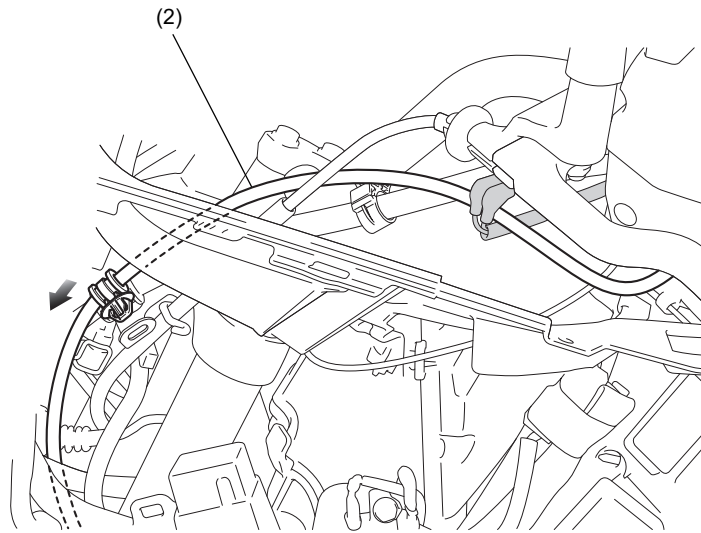

10. Secure the left grip heater harness as shown.

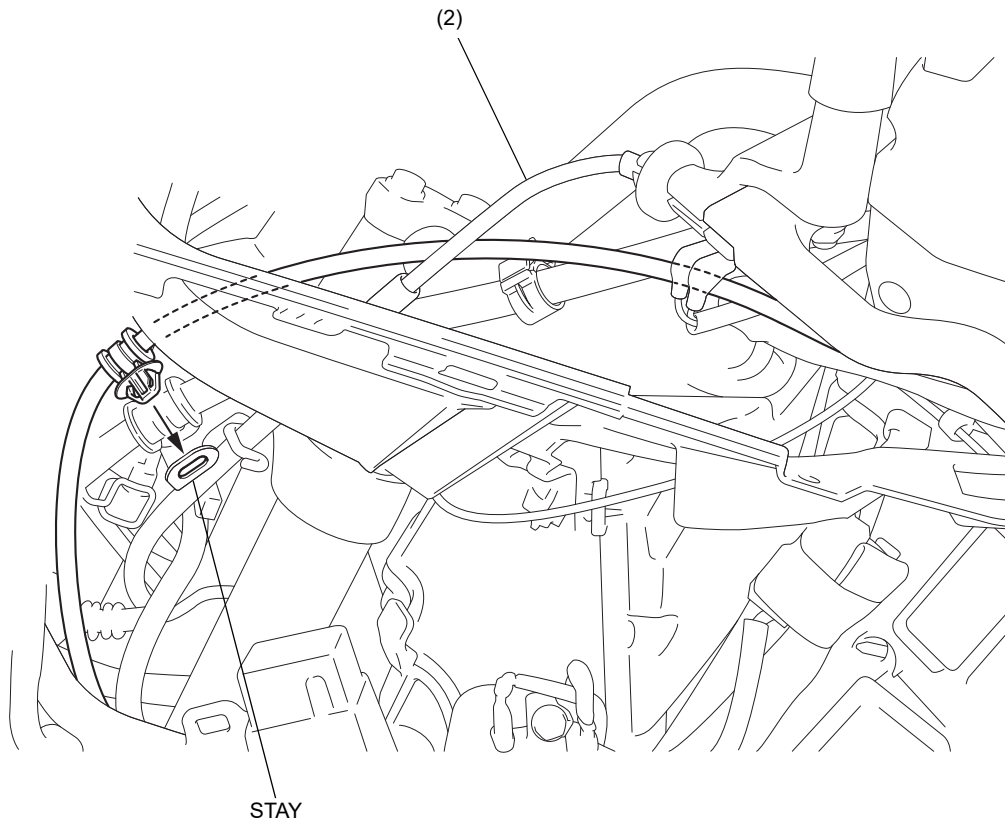

11. Secure the left grip heater harness with the cable clip as shown.

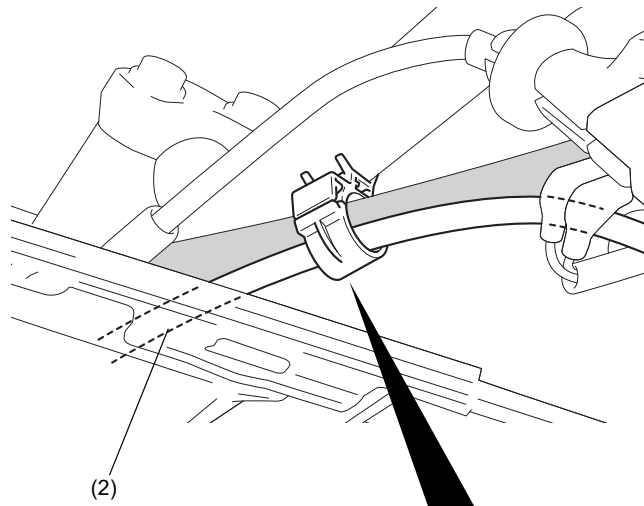

(2)

CABLE CLIP (Reuse)
Secure the left grip heater harness
and motorcycle's harness.

(2)

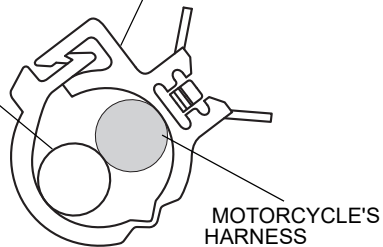

MOTORCYCLE'S
HARNESS

12. Route the left grip heater harness as shown.

<Left side>

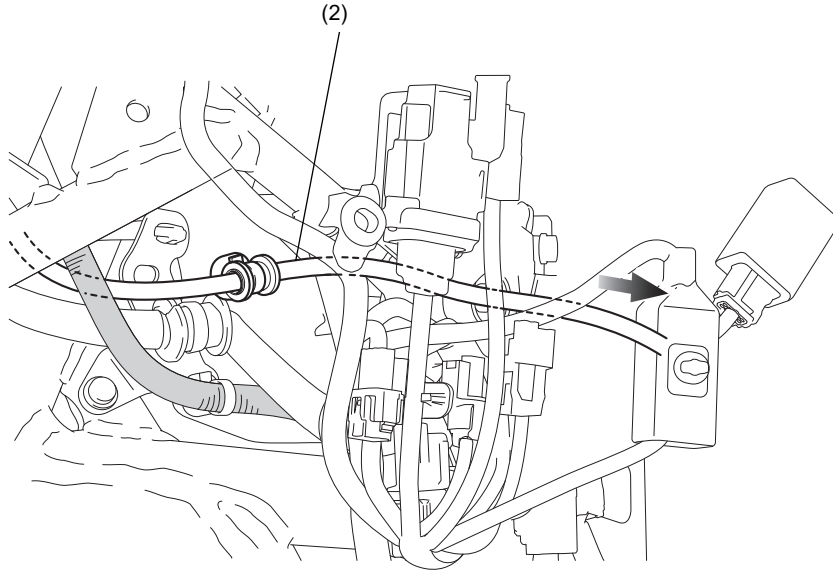

13. Secure the left grip heater harness as shown.

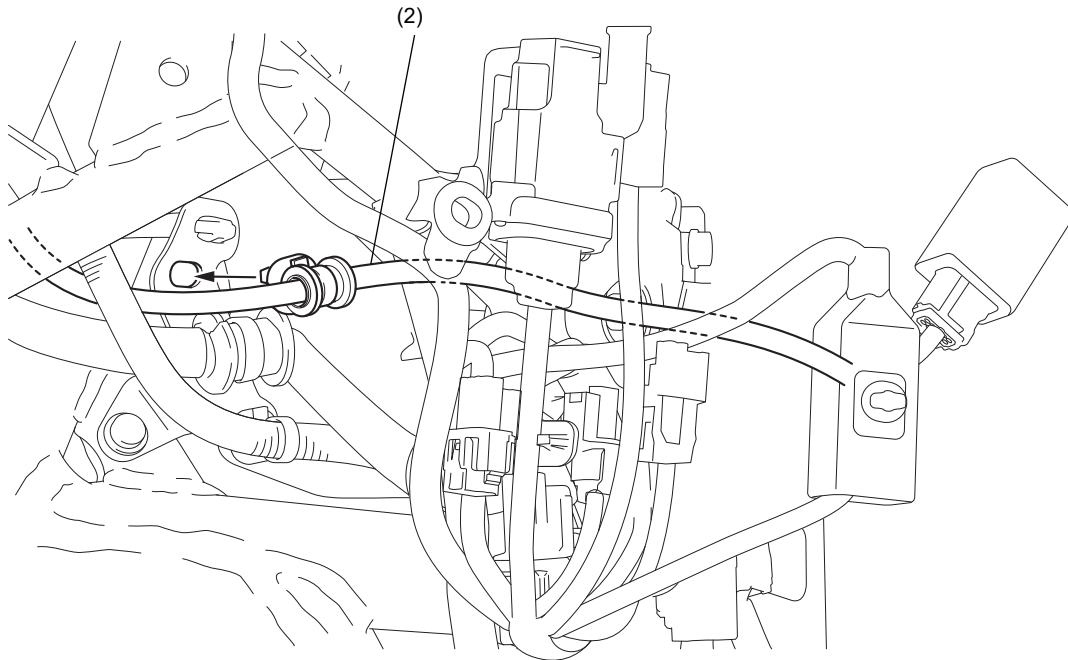

14. Secure the left grip heater harness as shown.

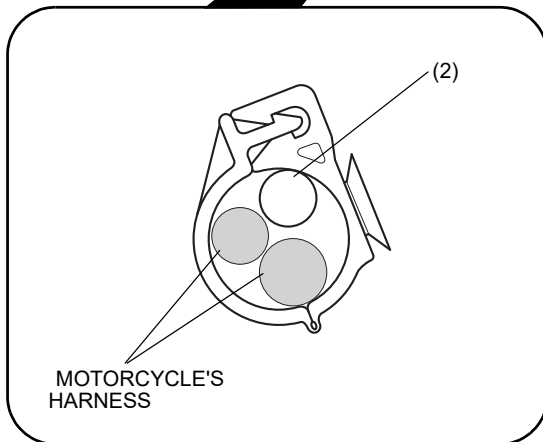
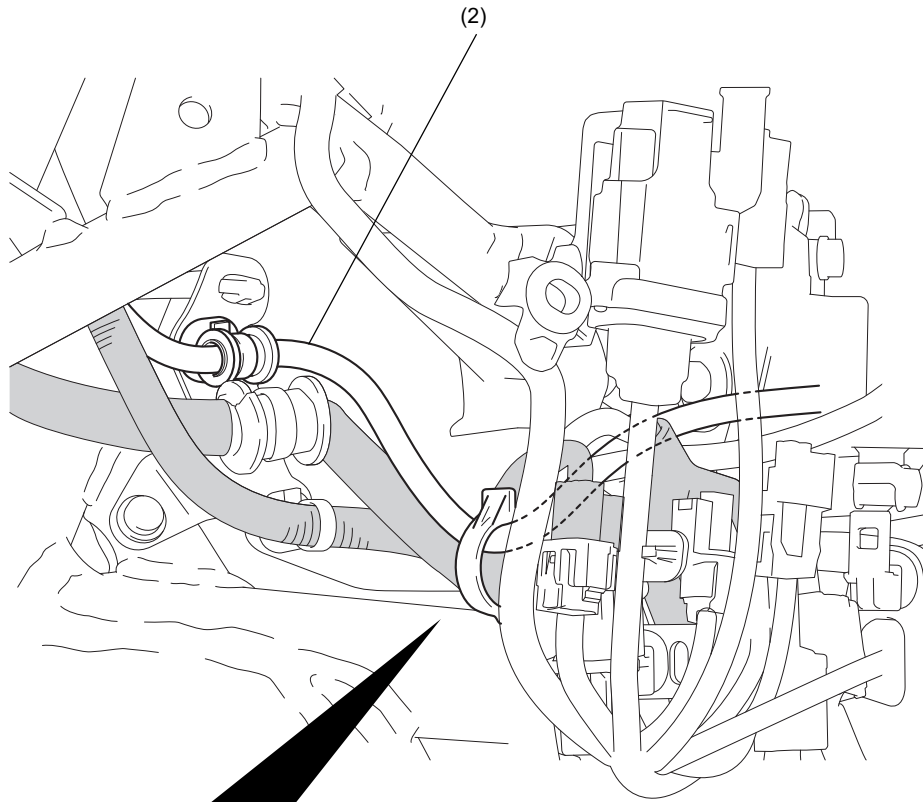

15. Remove the connectors as shown.

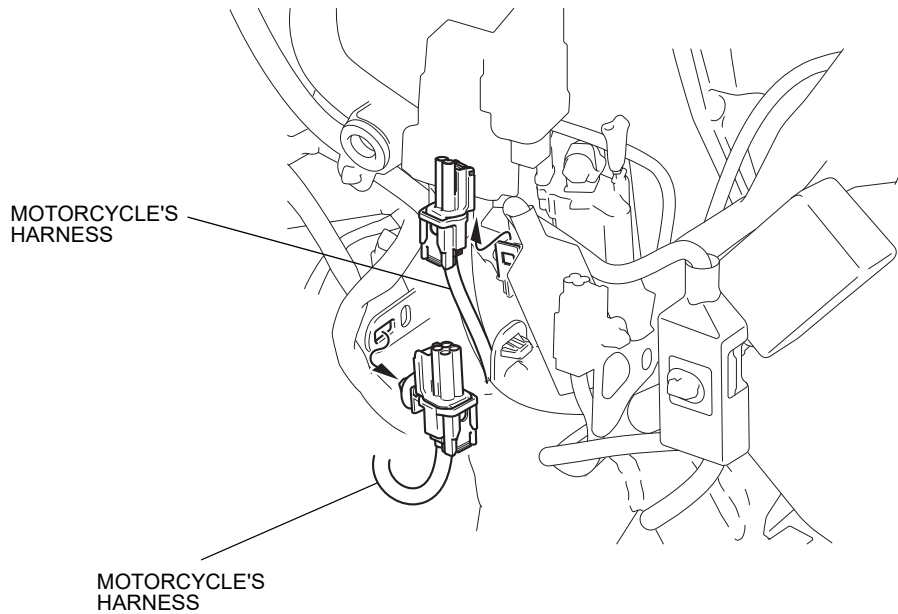

16. Remove the dummy connectors as shown.

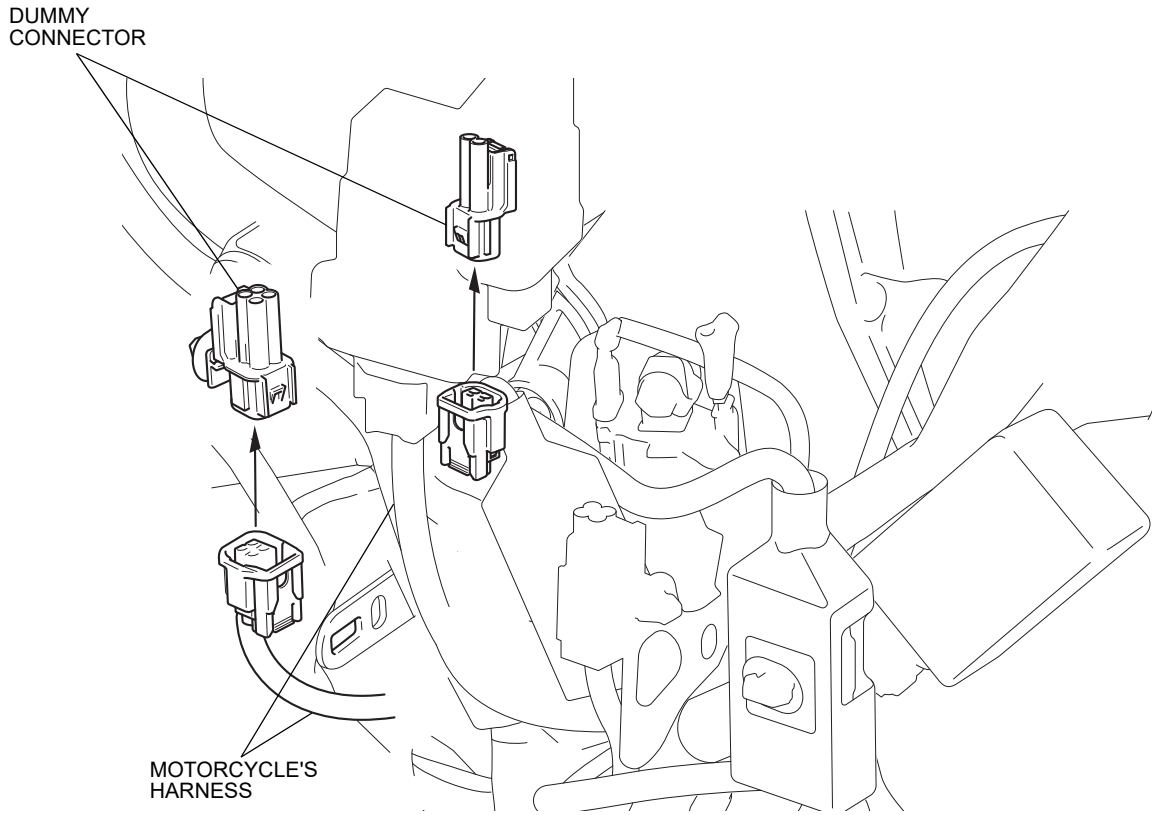

17. Connect the left grip heater harness as shown.

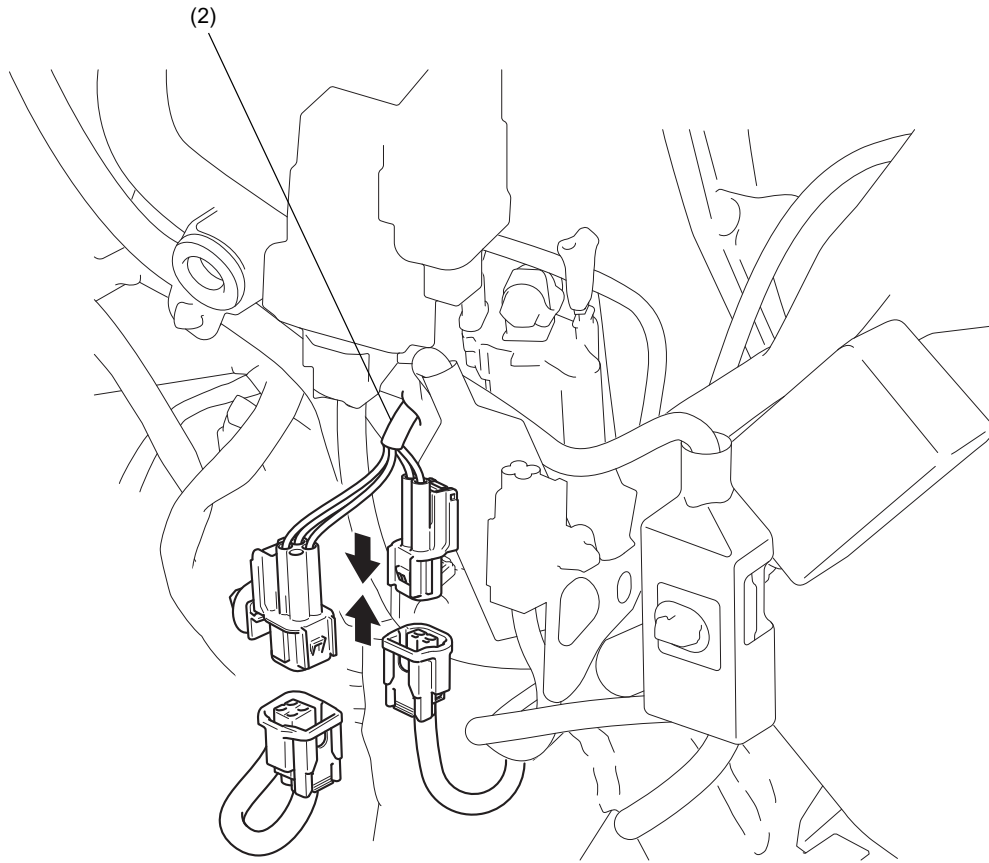

18. Secure the left grip heater harness as shown.



19. Install the suspension as shown.

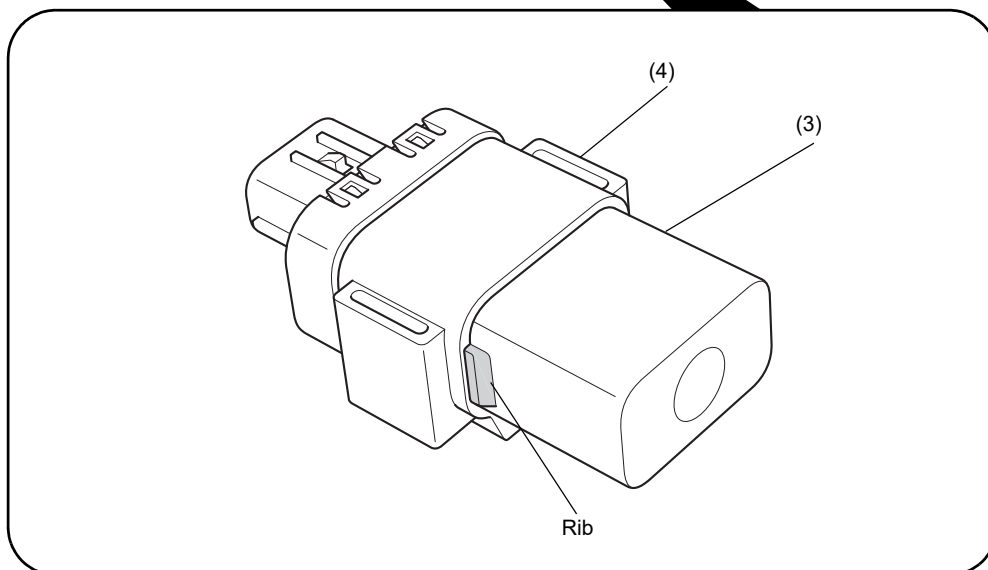
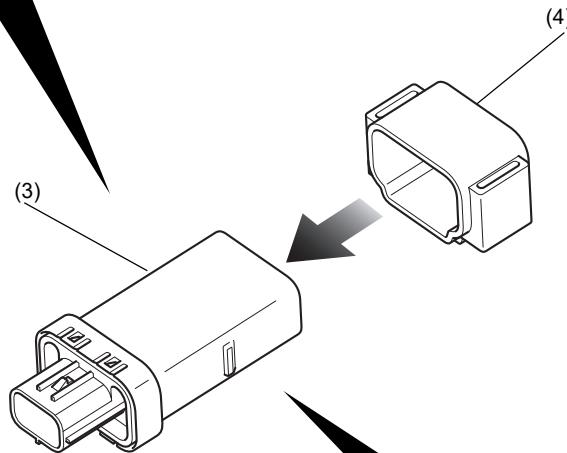
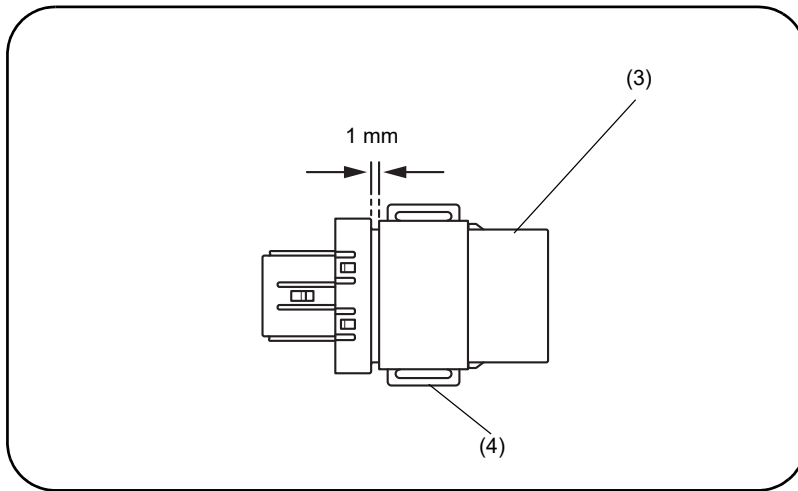

20. Remove the dummy connector as shown.

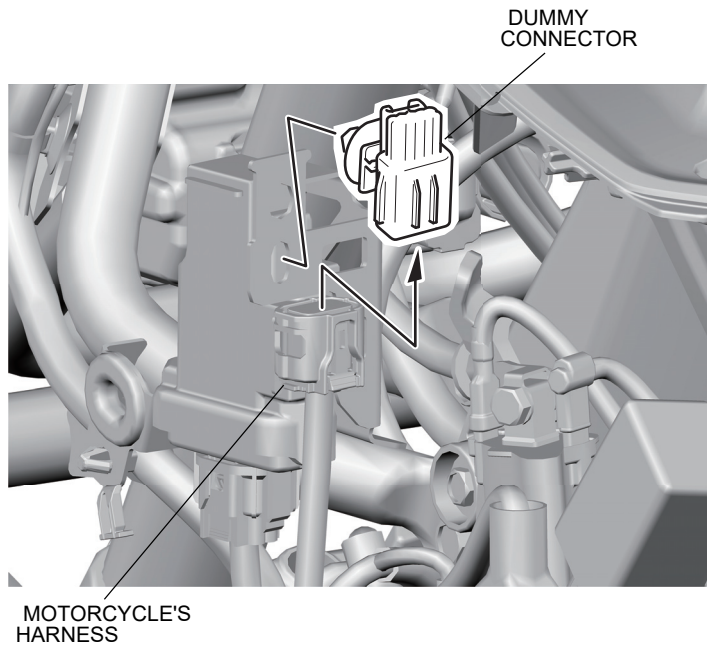

21. Connect and secure the heater controller as shown.

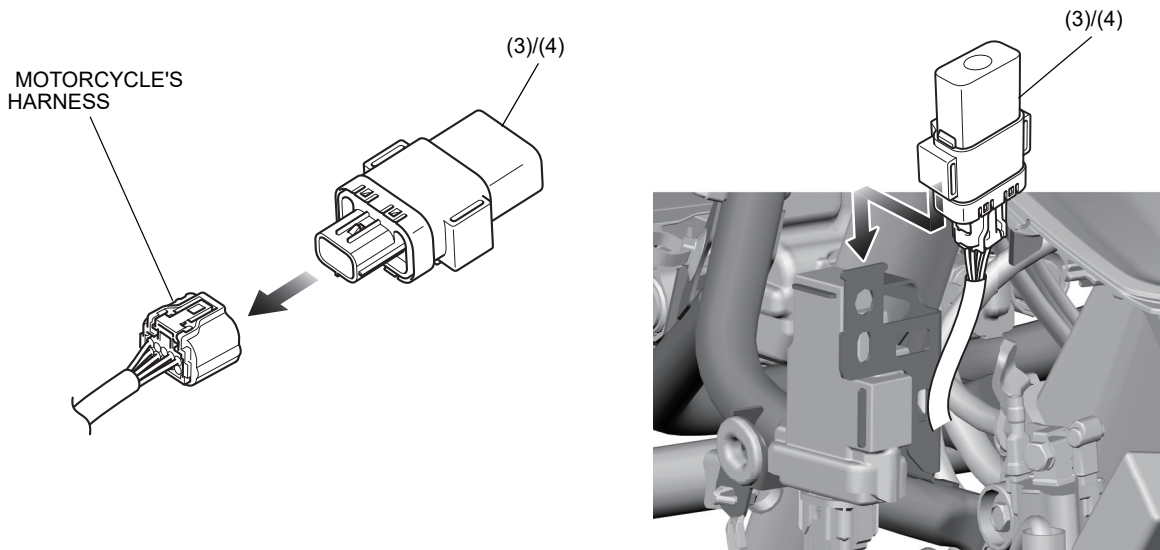

22. Loosen the bolts and move the brake master cylinder as shown.

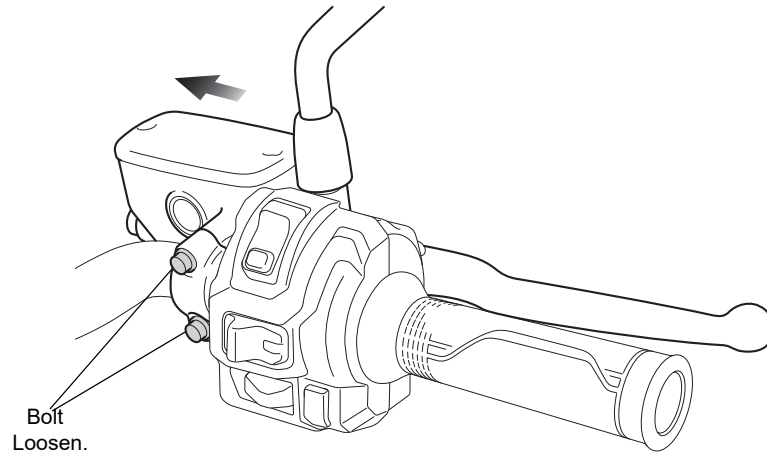

23. Remove the front case as shown.

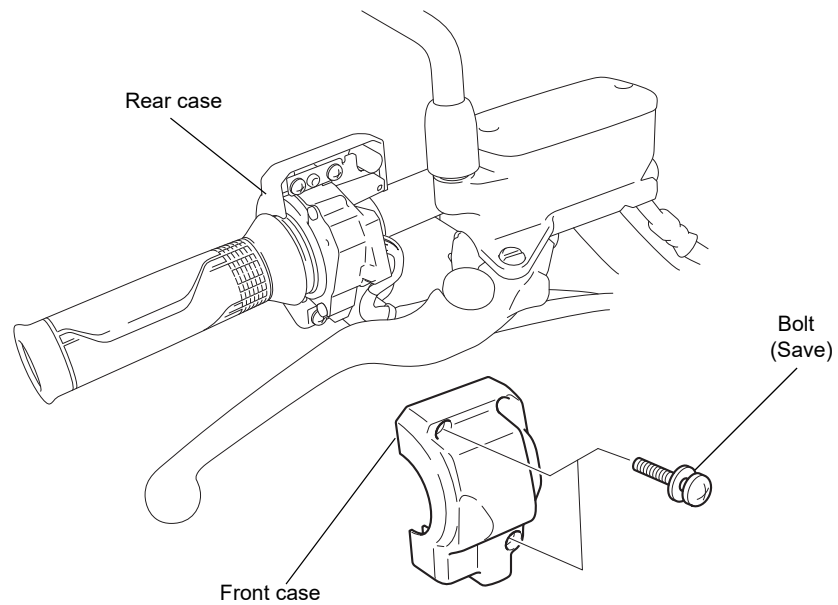

24. Remove the screws as shown.

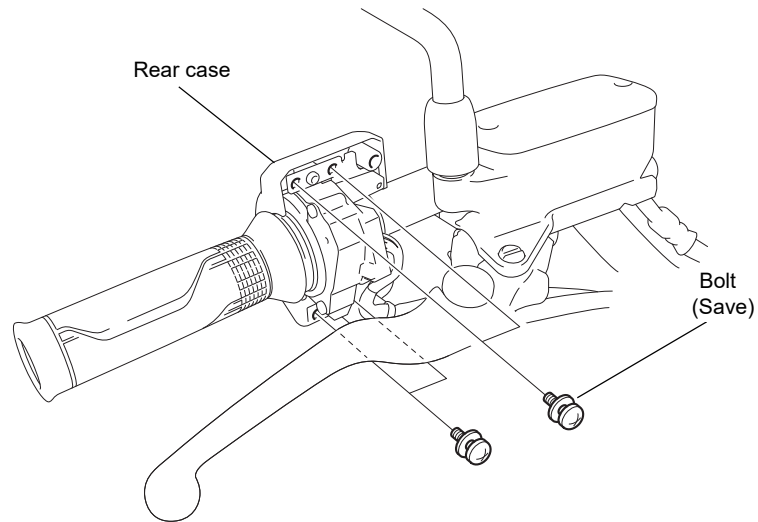

25. Remove the right grip as shown.

NOTE:

- Remove the right grip as instructed in the motorcycle's Service Manual.

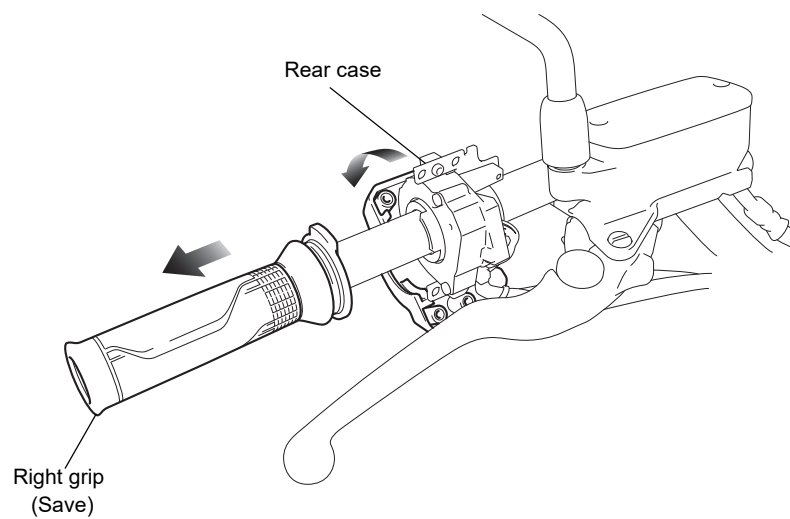

26. Apply grease to the hatched part as shown.

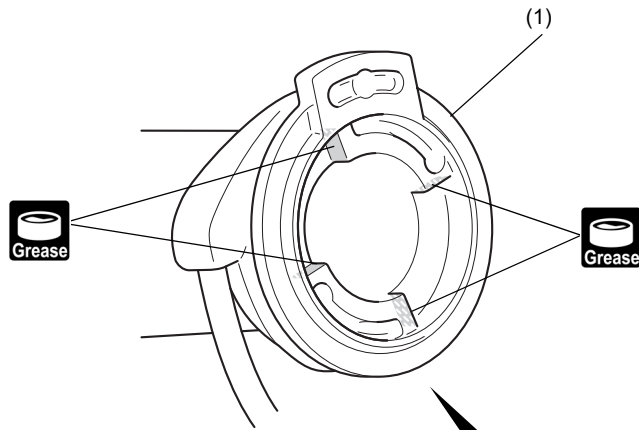

Be careful not to adhere grease to the outside of dimensions shown.

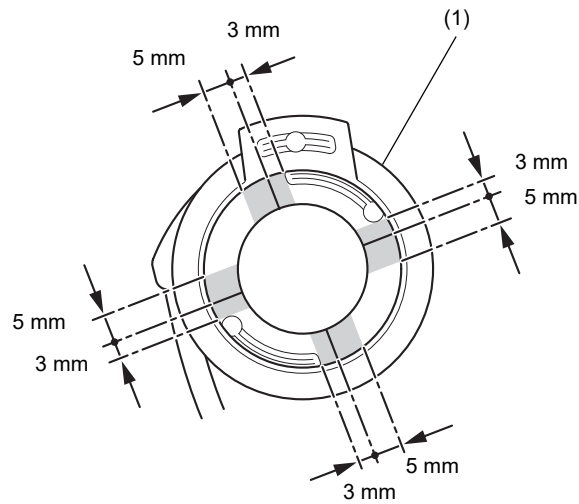

27. Apply grease to the hatched part as shown.

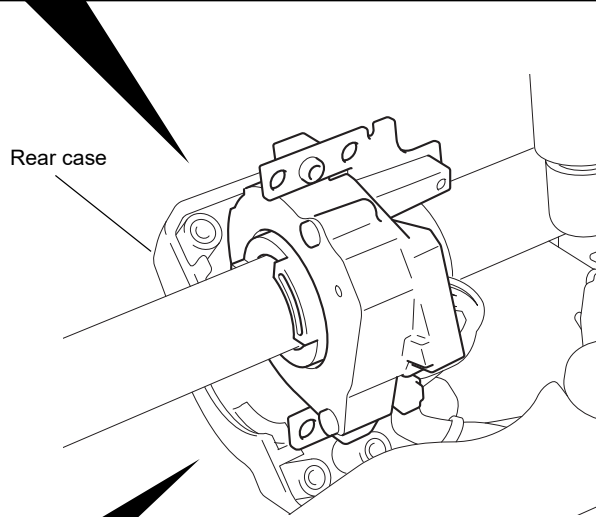
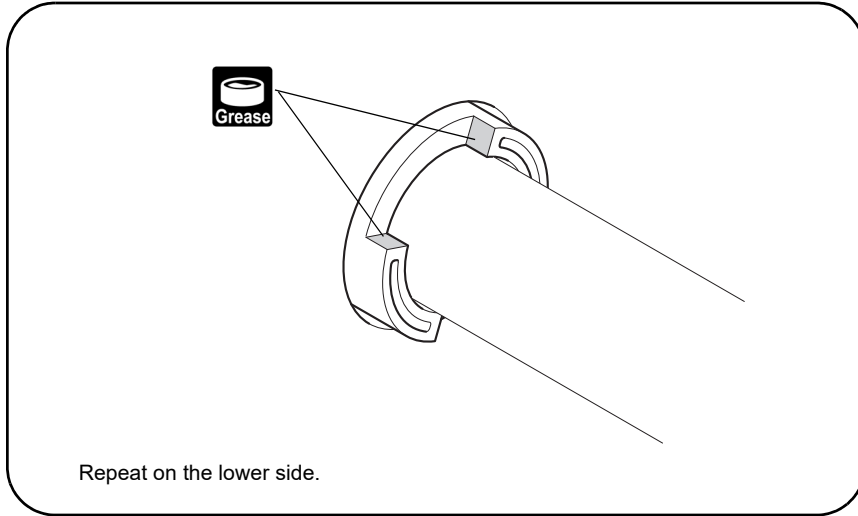

Be careful not to adhere grease to the outside of dimensions shown.

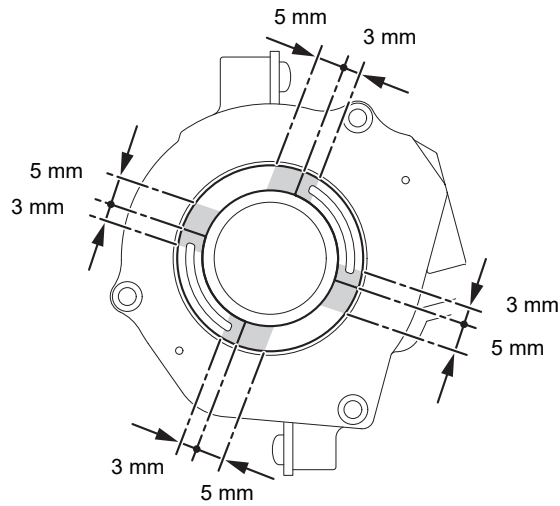

28. Install the right grip heater as shown.

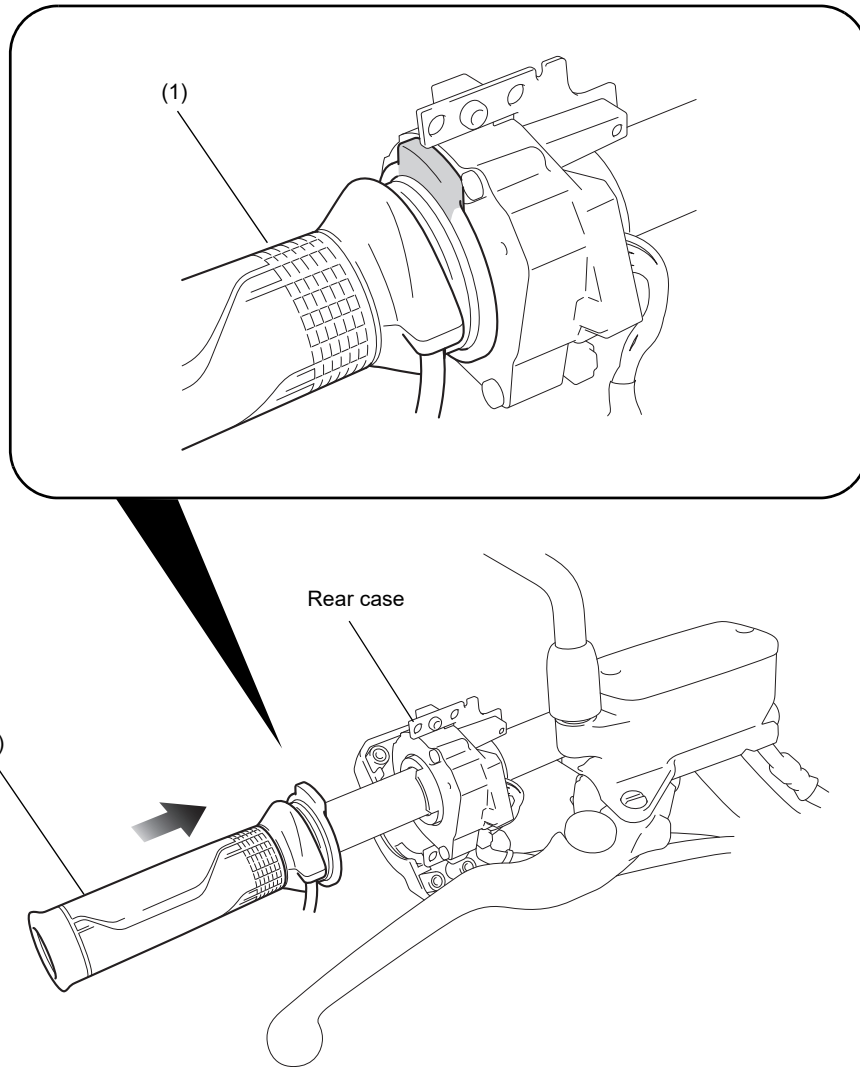

29. Install the front and rear case in the reverse order of removal.

30. Twist the throttle grip as shown.
- Check for smooth opening of the throttle and that it automatically snaps closed from any opening, in all steering positions.

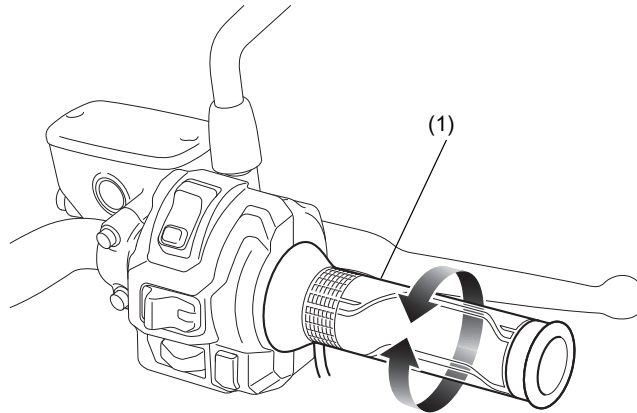

31. Remove the bolt as shown.

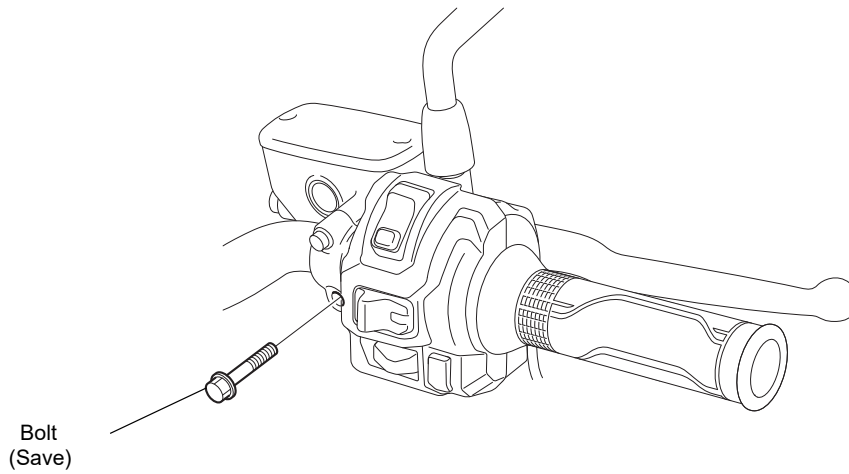

32. Install the clamp as shown.
- Tighten the upper bolt first, then tighten the lower bolt.

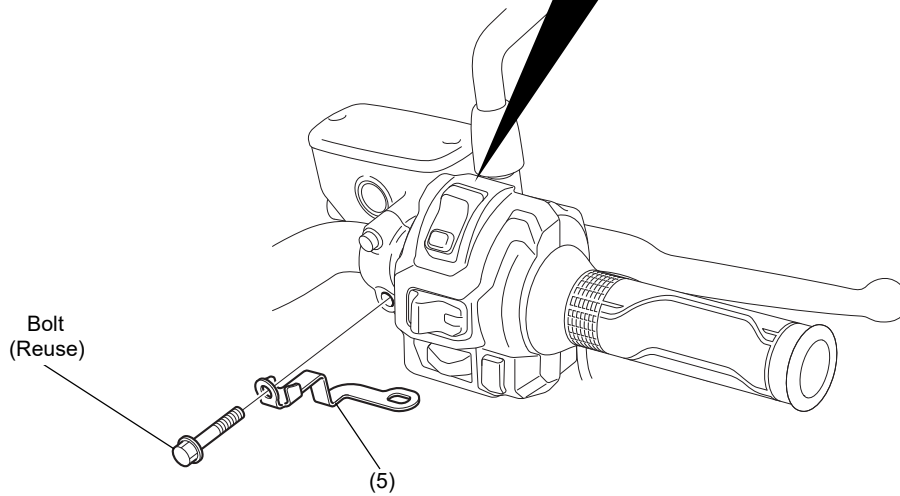
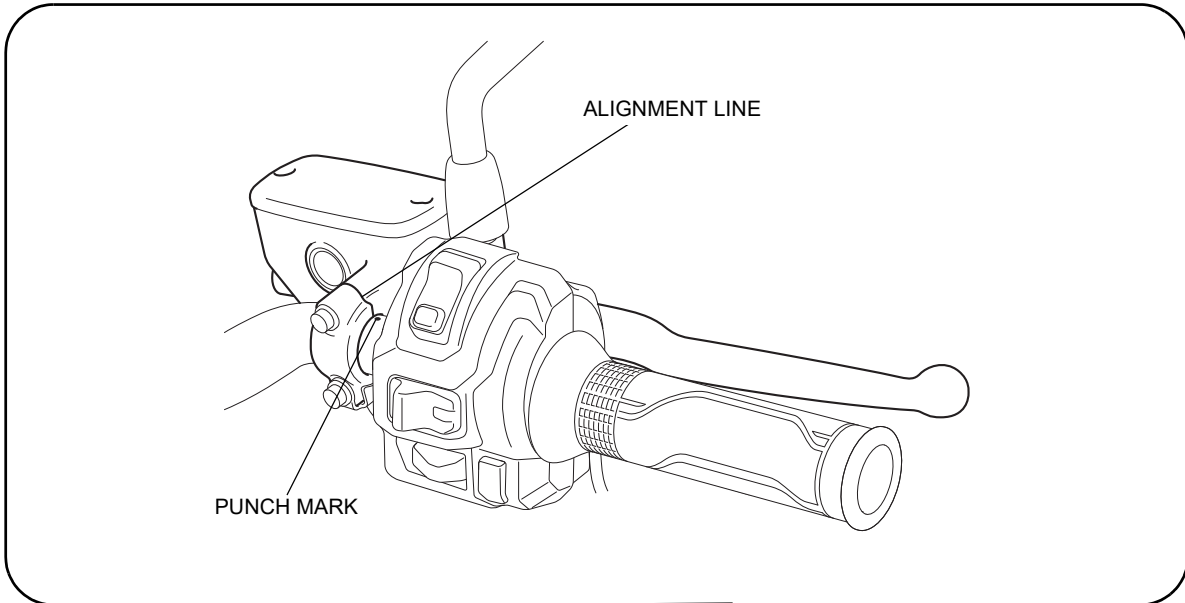

33. Secure the right grip heater harness as shown.
- Open and close the throttle and confirm that there is no tightness of the grip heater harness.

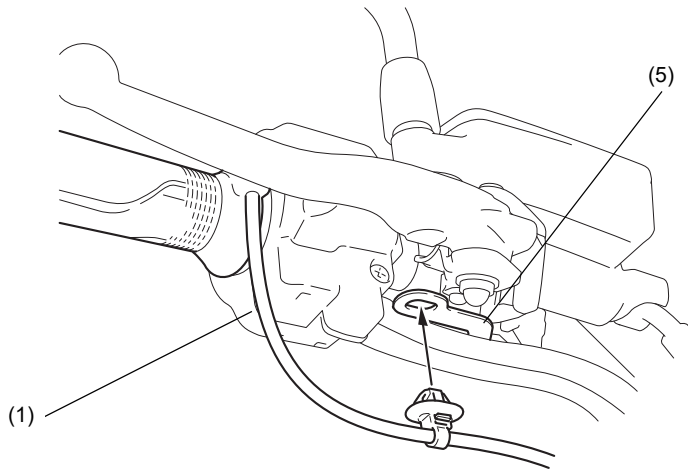

34. Route the right grip heater harness as shown.

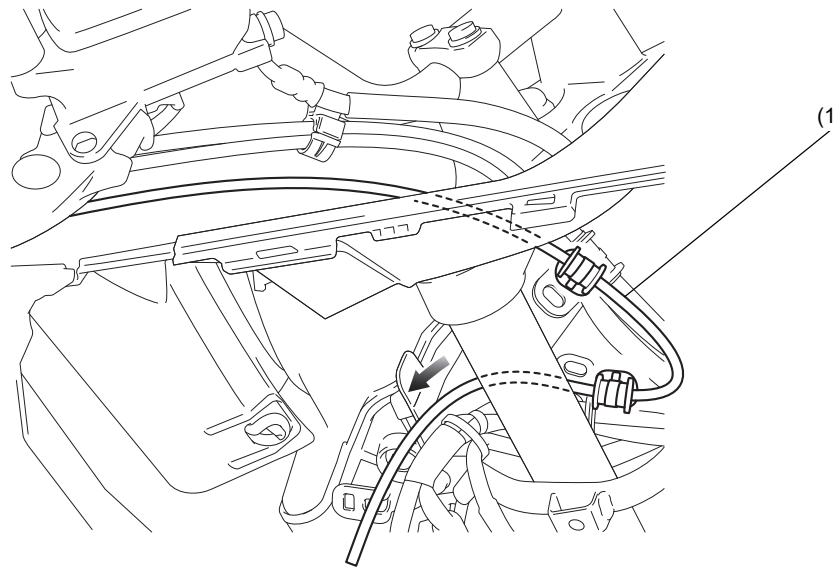

35. Secure the right grip heater harness as shown.

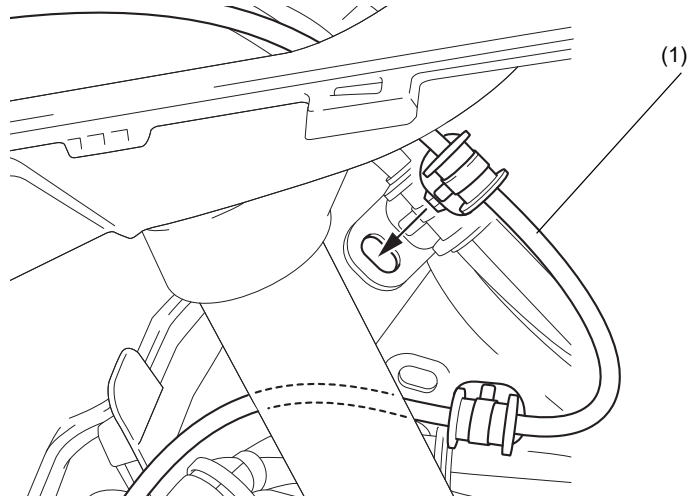

36. Secure the right grip heater harness with the clamps as shown.

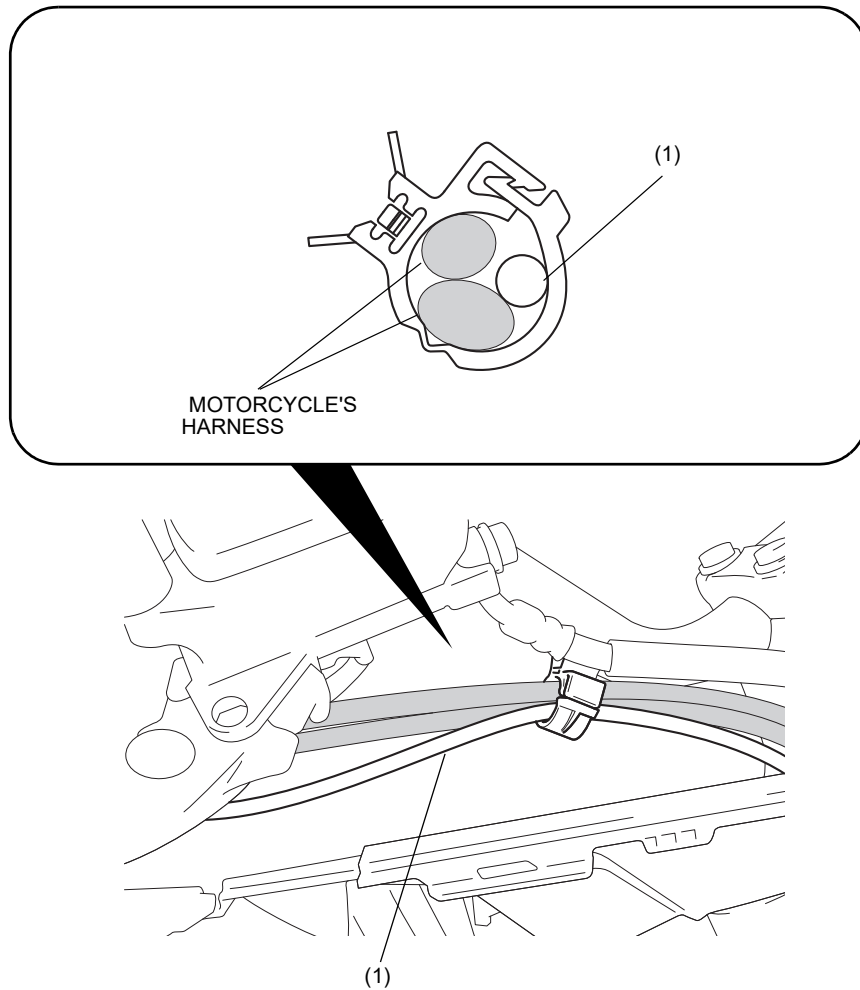

37. Remove the connector as shown.

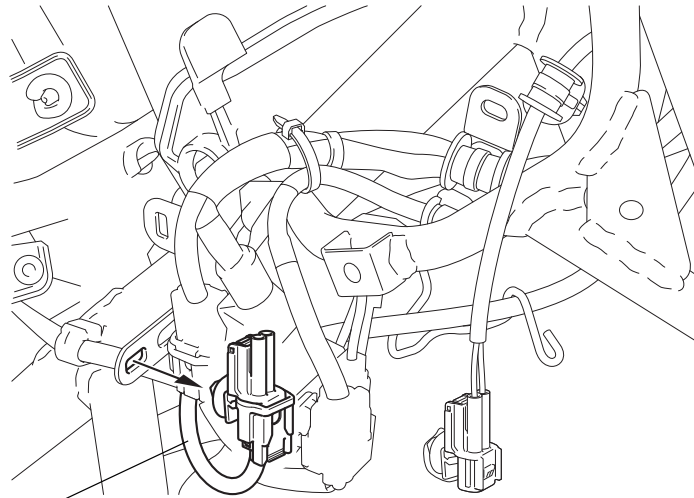

MOTORCYCLE'S
HARNESS

38. Remove the dummy connector as shown.

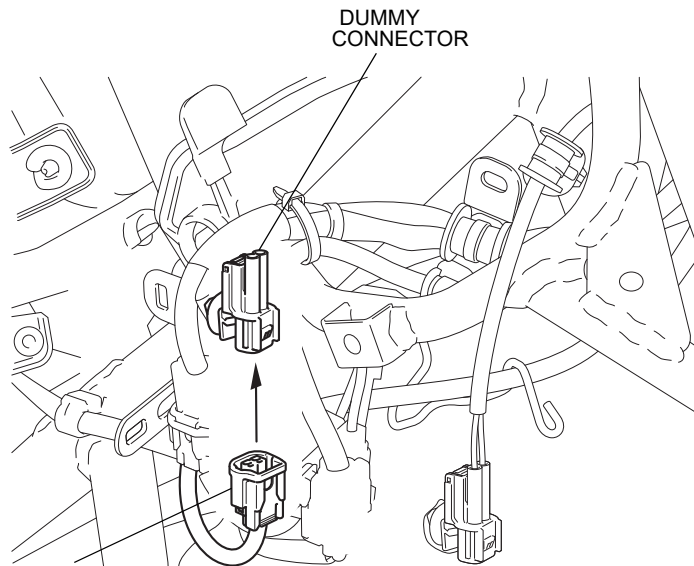

DUMMY
CONNECTOR

MOTORCYCLE'S
HARNESS

39. Secure the right grip heater harness as shown.

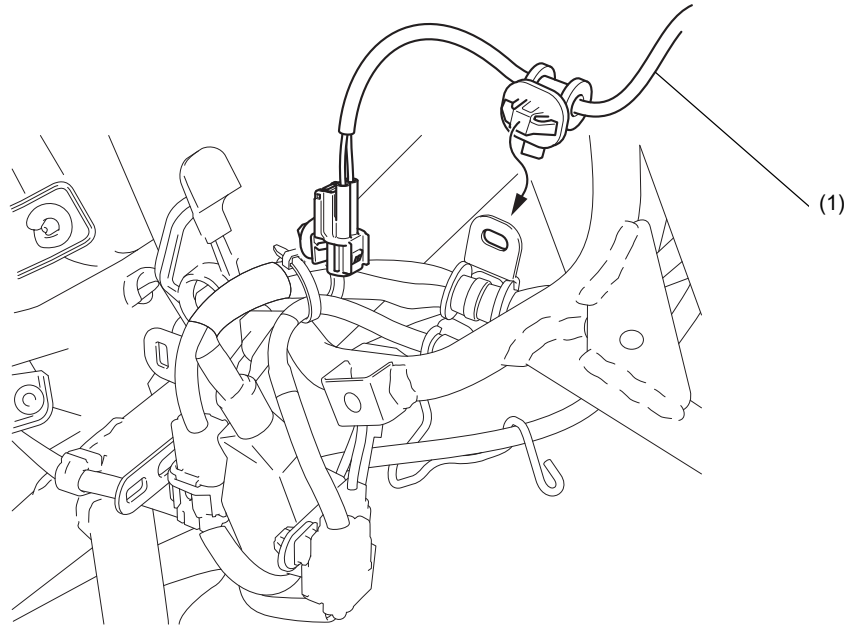

40. Connect the right grip heater harness as shown.

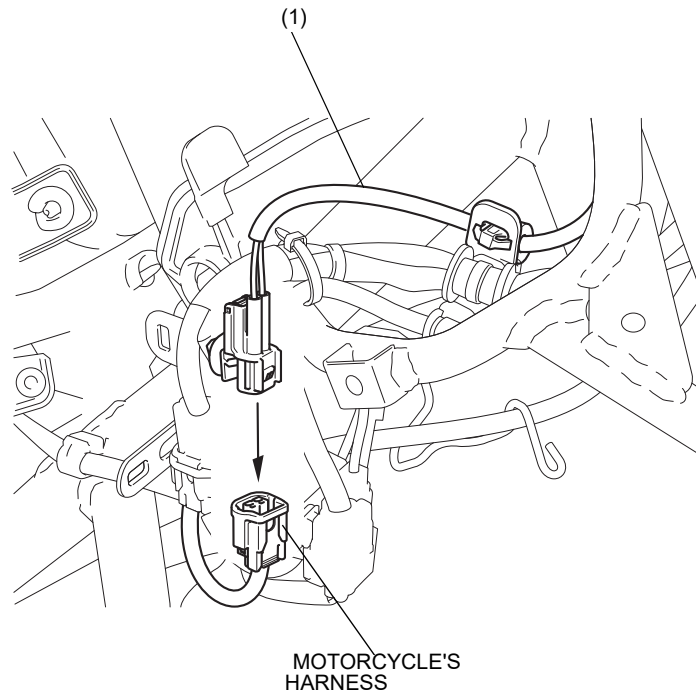

41. Secure the right grip heater harness as shown.

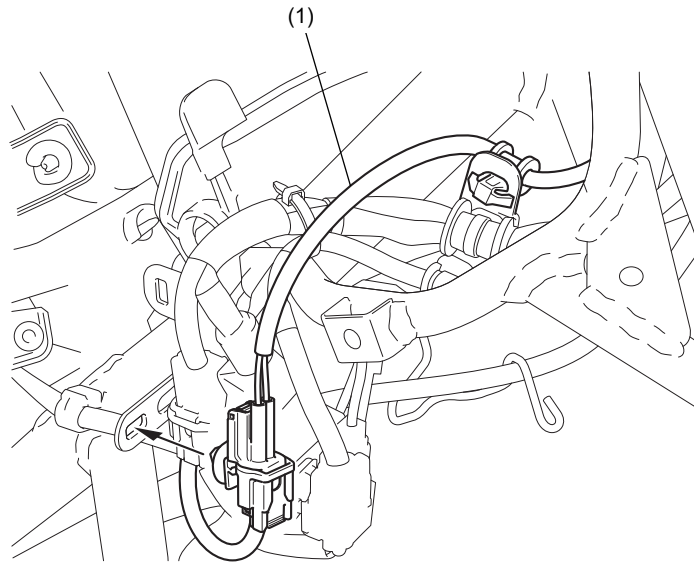

42. Secure the right grip heater harness as shown.

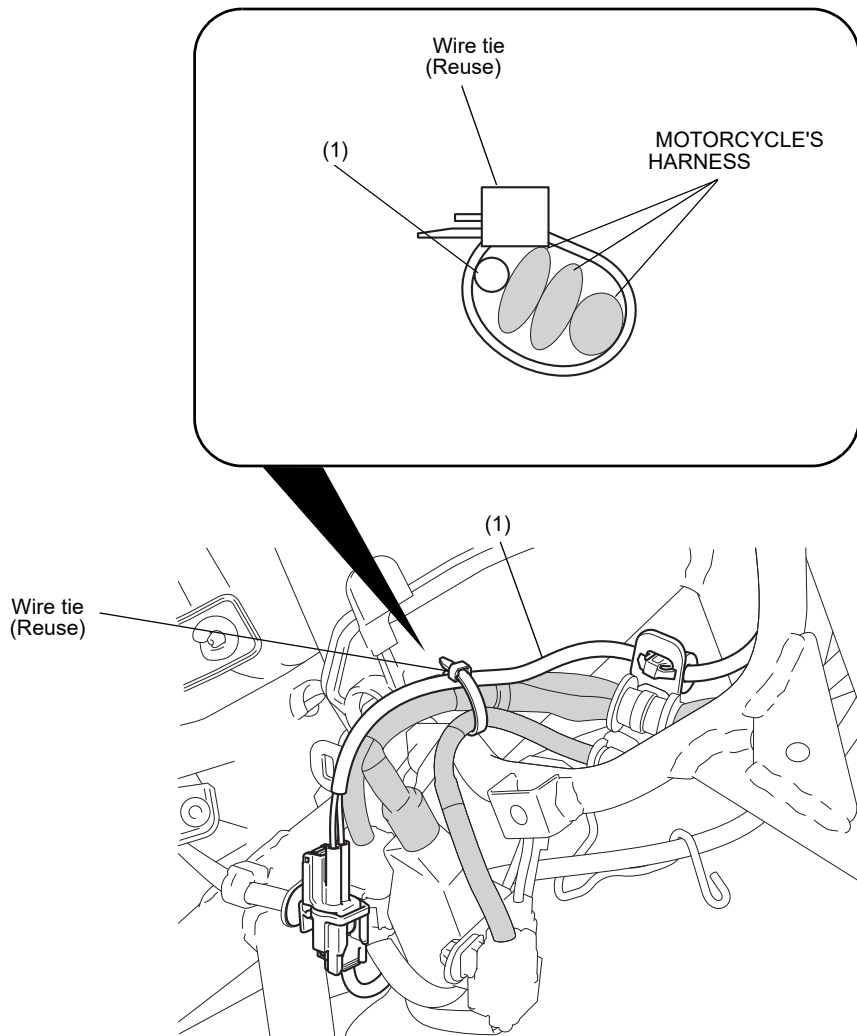

43. Check each harness for sufficient play.
• Move the handlebar right and left and check that the harnesses are not pinched by neighboring components and that they are not pulled taut.

44. Reinstall the parts as shown.
- Clean up with isopropyl alcohol before applying thread lock.
 - Be sure to apply to the threads of the screw.
 - Repeat on the right side.

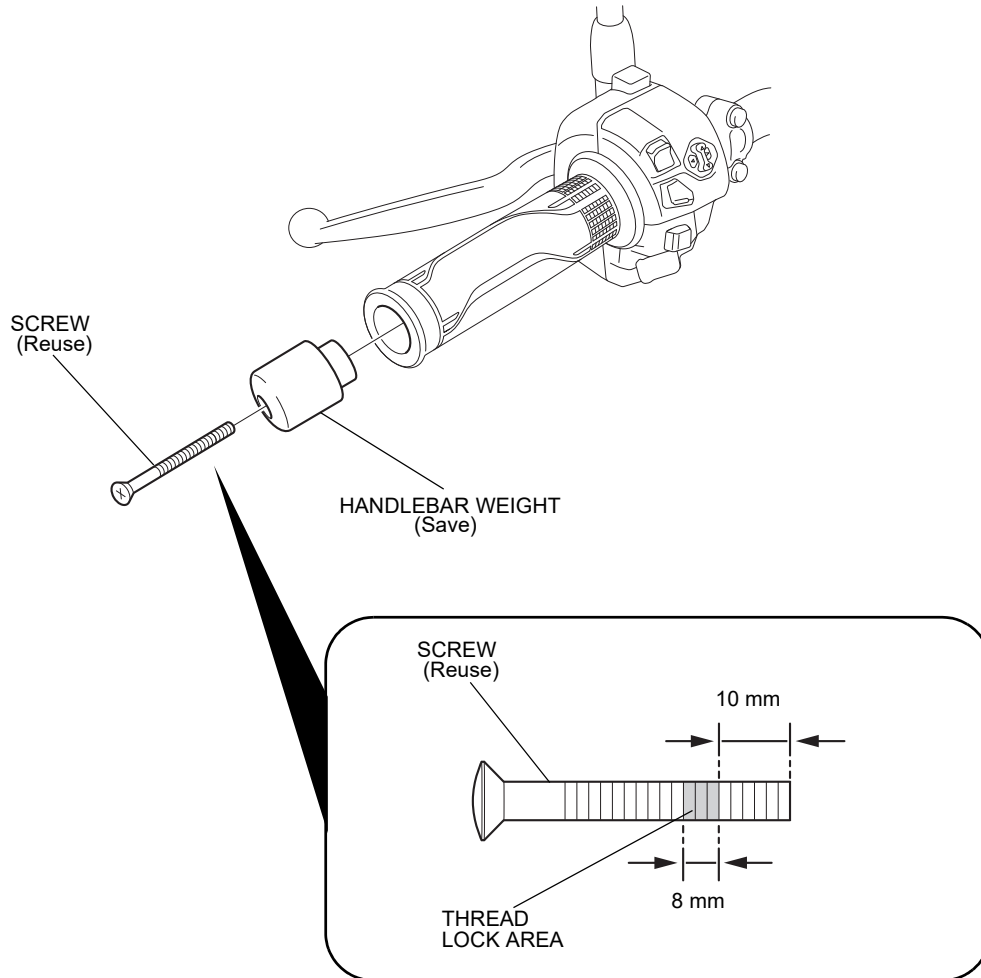

45. Secure the left grip heater harness with the wire tie as shown.

<Left side>

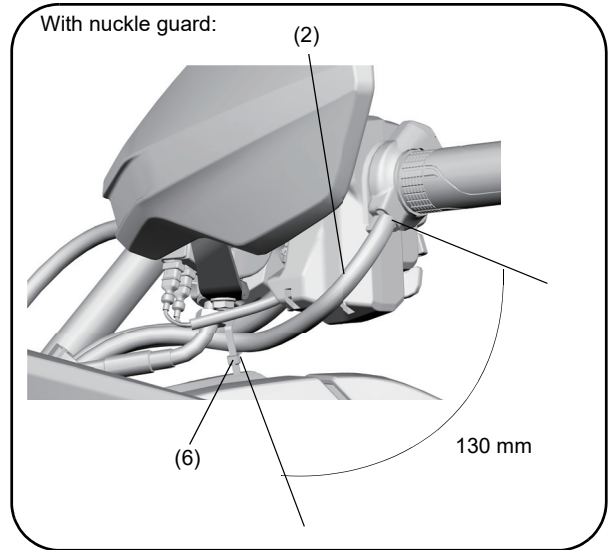
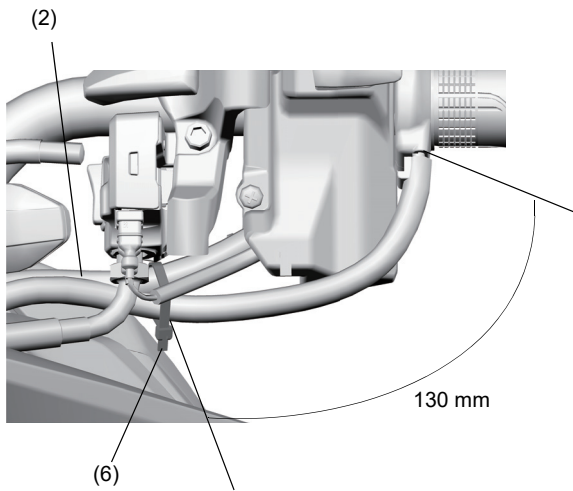

46. Install the motorcycle's parts in the reverse order of removal.
• Confirm that any wire harness is not caught or too tight.

47. Check the grip heater, throttle, headlight and the other lights for proper operation.

SETTING

1. Connect the SCS short connector (070MZ-0010300).
2. Turn the ignition switch ON.
3. Display the "SETTING" using the Sel switch.

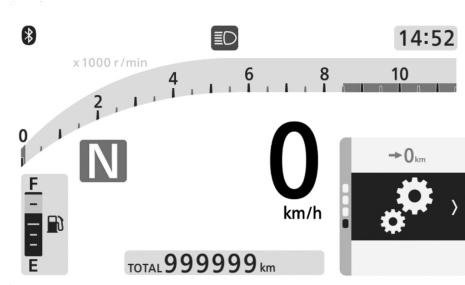
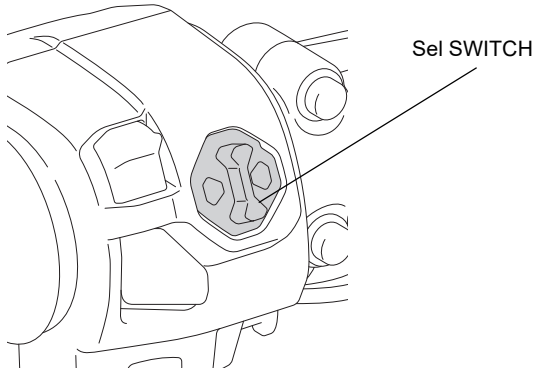

4. Select the "SERVICE", and then press the Sel switch ►.

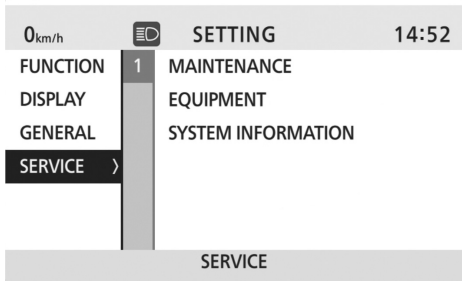

5. Select the "EQUIPMENT", and then press the Sel switch ►.

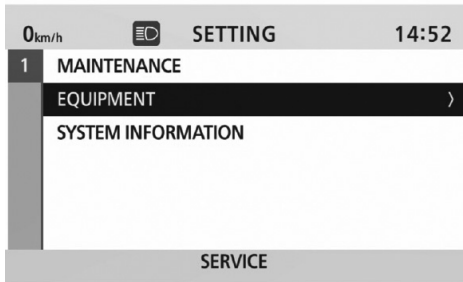

6. Select the "GRIP HEATER", and then press the Sel switch ►.

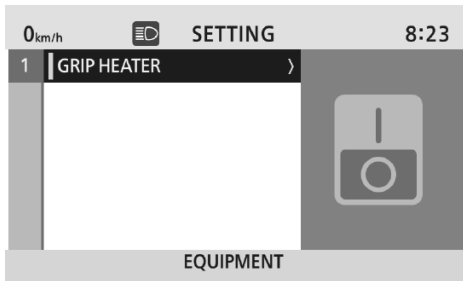

7. Press the Sel switch ▲ / ▼ to select "ON".

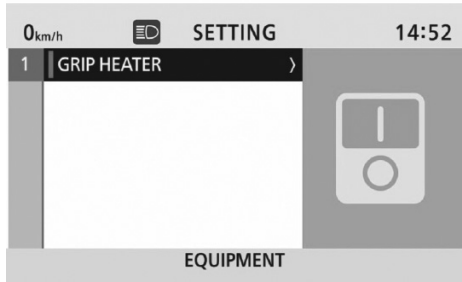

8. Press the Sel switch ◀, and then press and hold the Sel switch ▶ to return to the top screen.
9. Turn the ignition switch OFF and remove the SCS short connector.

DEALER TROUBLESHOOTING

- When the grip heater has abnormalities, the grip heater icon and level icon on the combination meter and the grip heater switch indicator show following displays. Follow each instruction to perform inspection.

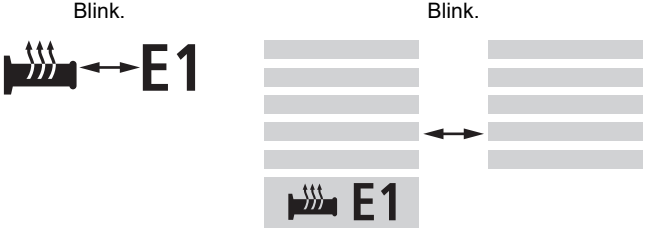
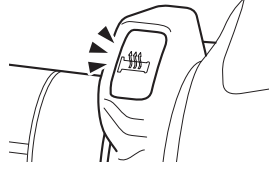
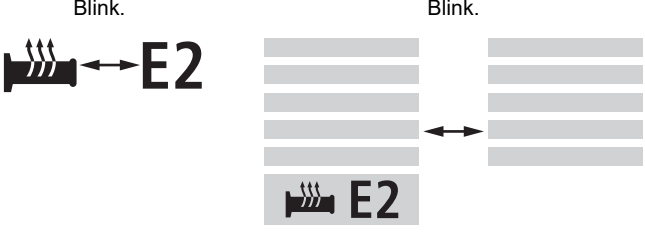
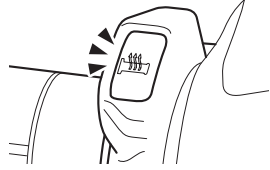
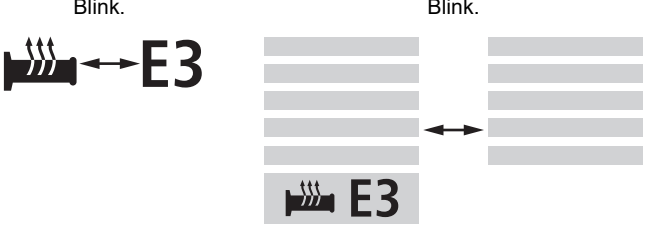
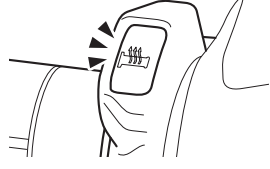
Grip heater icon and level icon (On the combination meter)	Grip heater switch indicator	Check
<p>Blink. Blink.</p> 	<p>Blink once.</p> 	1
<p>Blink. Blink.</p> 	<p>Blink twice.</p> 	2, 3, 4, 5
<p>Blink. Blink.</p> 	<p>Blink 3 times.</p> 	
-	Indicator does not light on.	6
Grip heater icon does light on.	-	

- Battery inspection:
Refer to the Service Manual and inspect the battery.
- Check whether wires and cables (terminals and connectors) are connected securely.
- Grip heater inspection:
Check for resistance between the terminals.
Right : 1.9 ohms +/- 10%
Left : 1.9 ohms +/- 10%
- Heater harness inspection:
Check for continuity.
- If no abnormality is found after the above checks 2, 3, and 4, but the grip heater still does not operate properly, replace the grip heater with a new one.
 - It is hard to check the switch with ordinary inspection methods (for continuity, voltage, etc.) because it contains an integrated circuit.
- Circuit of grip heater icon inspection:
Refer to Service Manual and inspect the circuit of grip heater icon.